

LVA 18/220-240/400 LG CH

General Benefits

Ripple Free (Flicker Free with <5%)
Better Reliability with high Tc
High Power Factor
Life upto 50,000 burning Hrs



Application

Down Lights
Spot Lights

Approvals

BIS as per IS 15885 (Part 2/Sec. 13)



Lucevita LED Power supply are with high reliability in compact housing having best surge protection, THD, Ripple Current in the industry.

Drivers generally used in Panel & Spot light application luminaires for residential, retail and Office space lighting.

Constant Current Analog Dimmable LED Driver

Professional Series

Product Specification Sheet

www.lucevita.in

LVA 18/220-240/400 LG CH

Features

Output Type		Constant Current
Dimming Type		1-10V
Dimming Range		10%-100%
IP Grade		IP 20
Insulation Class		Class II

Input

Rated Input Voltage		220 - 240 Vac
Range of Input Voltage		198-264 Vac
Frequency		50-60 Hz
Input Current		$\leq 0.22A$ (198VAC, full load)
Input Power		$\leq 43W$ (230VAC, full load)
Power Factor		≥ 0.92 (230VAC, full load)
THD		$\leq 20\%$ (230VAC, full load)
No Load Power		$\leq 0.5W$ @ 230VAC
In Rush Current		$\leq 25A/2.4\mu s$ (230VAC, full load)

Output

Output Current		250/300/350/400mA
Output Voltage		30-42VDC
Output Power		35.7W
Constant Current Accuracy		$\pm 5\%$
No Load Output Voltage		59 VDC Max.
Current Ripple		$\pm 3\%$ ($I_{max}-I_{min}$) / ($I_{max}+I_{min}$)
Efficiency		$\geq 80\%$
Start Delay Time		≤ 0.5 Second (230VAC, full load)

Protection

Short Circuit Protection		Auto Recovery
Overload Protection		Auto Recovery
No-load Protection		Auto Recovery
Leakage current		I/P to O/P < 250 μA
Insulation voltage		I/P to O/P, 3KVAC/1min
Insulation resistance		>100M ohm @ 500VDC
Surge Protection		L-N/1KV

Environment

Ta/Operation Temperature		18W,21W,33W,35W : -25...+50°C
Ts/Storage Temperature		-10....+75°C
Tc/ Enclosure Temperature		75°C
Humidity		10%....90%RH
Atmosphere		86-108KPa

Construction

Connection Method		Push-in Terminal
Installation		Built-in & Independent
PRI Wire Preparation		0.75-1.5 \square
SEC Wire Preparation		0.5-1.5 \square
Dimension		Independent:137.6*44*30mm (L*W*H) Built in:97.8*44*30mm(L*W*H)

Constant Current Analog Dimmable LED Driver

Professional Series

Product Specification Sheet

www.lucevita.in

LVA 18/220-240/400 LG CH

Standards

Certification	Complied to CE ENEC SAA
Safety Standards	EN61347-1:2015, EN61347-2-13:2014/A1:2017, EN61347-1:2015, EN61347-2-13:2014/A1:2017, AS/NZS 61347.1:2016
EMC Standards	EN55015:2013/A1:2015, EN61000-3-2:2014, EN61000-3-3:2013, EN61547:2009
Performance	EN62384

Others

RoHS	Complied to 2011/65/EU
Lifetime	50,000 Hrs@Tc=50°C (Ta) / 85°C (Tc)
Warranty	3 Years, F.R. <10000ppm

3. Dimension (Unit, mm)

Independent type:

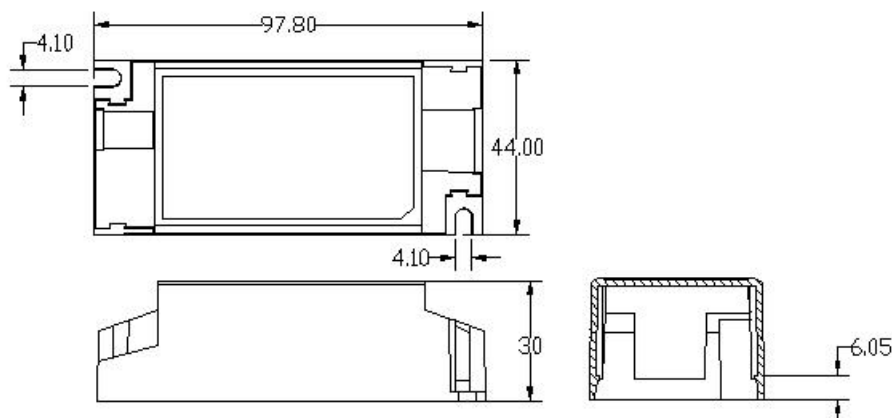

4. Wiring Diagram

Independent type

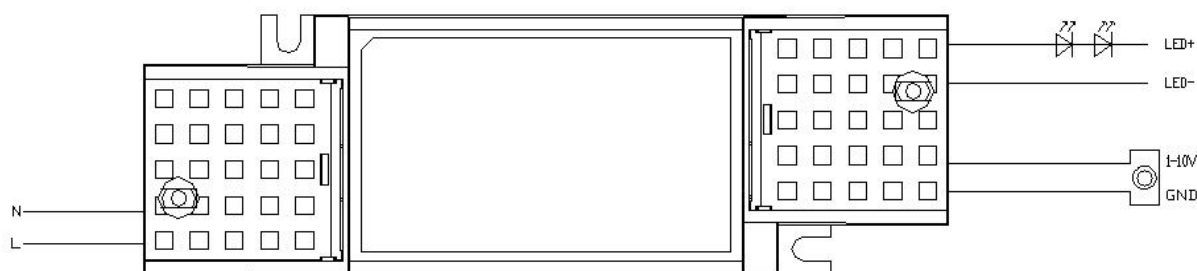

Constant Current Analog Dimmable LED Driver

Professional Series

Product Specification Sheet

www.lucevita.in

LVA 18/220-240/400 LG CH

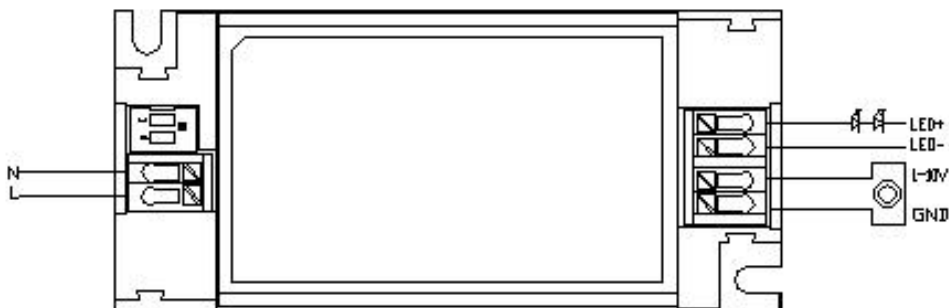

Remarks

1. All Parameters, if not specified, are measured at 230VAC/50Hz and 25°C ambient temperature.
2. LED Driver is a component of the luminaires, Luminaires and wire layout will affect the EMC, please check the EMC with end products again.
3. Warranty Mentioned is a limited warranty only to the original purchaser or to the first user @ Tc max from the date of manufacturing when properly installed and operated under normal conditions of use.
4. Please refer our website for details warranty conditions.
5. For further details, kindly refer our website. www.lucevita.in, or email info@lucevita.in.